

Manual of Operation and Instruction

Model 3411-B Advanced Control Unit



Troxler Electronic Laboratories, Inc.

3008 Cornwallis Rd. • P.O. Box 12057

Research Triangle Park, NC 27709

Phone: 1.877.TROXLER

Outside the USA: +1.919.549.8661

Fax: +1.919.549.0761

www.troxlerlabs.com

Troxler gauges are protected by U.S. and foreign patents.

Copyright © 2005, 2006

**Troxler Electronic Laboratories, Inc.
All Rights Reserved**

No part of this manual may be reproduced or transmitted in any form or by any means, electronic or mechanical, including photocopying, recording, or information storage and retrieval systems, for any purpose without the express written permission of Troxler Electronic Laboratories, Inc.

PN 110247
February 2006
Edition 2.1

TROXLER SERVICE CENTERS

Troxler Corporate Headquarters

3008 Cornwallis Road

P.O. Box 12057

Research Triangle Park, NC 27709

Phone: 1.877.TROXLER (1.877.876.9537)

Outside the U.S.A.: +1.919.549.8661

Fax: +1.919.549.0761

Web: www.troxlerlabs.com

Technical Support

Phone: 1.877.TROXLER (1.877.876.9537)

E-mail: TroxTechSupport@troxlerlabs.com

Midwestern Branch Office

1430 Brook Drive

Downers Grove, IL 60515

Fax: 630.261.9341

Florida Service Center

2376 Forsyth Road

Orlando, FL 32807

Fax: 407.681.3188

Western Regional Branch Office

11300 Sanders Drive, Suite 7

Rancho Cordova, CA 95742

Fax: 916.631.0541

Canadian Branch Office

7125 Pacific Circle, Unit 13

Mississauga, Ontario L5T-2A5

Canada

Fax: 905.564.7092

Southwestern Branch Office

2016 East Randol Mill Road

Suite 406

Arlington, TX 76011

Fax: 817.275.8562

Troxler European Subsidiary

Troxler Electronics GmbH

Gilchinger Strasse 33

D.82239 Alling nr. Munich, Germany

Phone: ++49.8141.71063

Fax: ++49.8141.80731

E-mail: troxler@t-online.de

HOW TO USE THIS MANUAL

Congratulations on the purchase of the **Troxler Model 3411-B Advanced Control Unit (ACU)**. The ACU enables the owner of a Troxler Model 3411-B Surface Moisture-Density Gauge to enjoy all the features and functions of our Model 3430 gauge for less than the cost of a new gauge.

The *Model 3411-B Advanced Control Unit Manual of Operation and Instruction* contains information on installing the ACU, and on safely using the Model 3411-B gauge after the ACU has been installed. Also included in this manual are safety warnings, gauge setup, troubleshooting, and general maintenance information.

CONVENTIONS USED IN THIS MANUAL

Throughout this manual, symbols and special formatting are used to reveal the purpose of the text as follows:

WARNING

Indicates conditions or procedures that, if not followed correctly, may cause personal injury.

CAUTION

Indicates conditions or procedures that, if not followed correctly, may cause equipment damage.

NOTE

Indicates important information that must be read to ensure proper operation.

<Key> Angle brackets and a different typestyle indicate a key or character (number or letter) to press on the ACU keypad. For example, “Press **<STD>**” means to press the key labeled *STD*.

Display A different typestyle is used in text to indicate information or messages displayed on the ACU.

**DISPLAY- Shading
& typestyle used
to simulate ACU
display.***

- ◆ Diamonds indicate a list of things needed (such as equipment) or things to know.
- ✓ Check marks indicate the performance of an action. With lists of check marks, follow the instructions in the order of the check marks.
- ▶ Triangles indicate that more than one option is available. Carefully select the option that applies.

* *The ACU is equipped with a two-line backlit display.*

NOTES

TABLE OF CONTENTS

CHAPTER 1. INTRODUCTION AND INSTALLATION

Introduction.....	1-2
Installing the ACU.....	1-3
Entering the Calibration Constants.....	1-4

CHAPTER 2. OPERATING THE GAUGE

The Keypad.....	2-2
Turning the Gauge On.....	2-4
Gauge Parameter Setup.....	2-5
Taking the Standard Count.....	2-8
Site Preparation/Gauge Positioning.....	2-10
Taking a Measurement – Soil Mode.....	2-13
Taking a Measurement – Asphalt Mode.....	2-16

CHAPTER 3. ADVANCED GAUGE OPERATION

Offsets.....	3-2
Special Calibrations.....	3-8
Thin Layer Measurements.....	3-12

CHAPTER 4. SPECIAL FUNCTIONS

Recall.....	4-2
Offset.....	4-2
Stat Test.....	4-2
Drift Test.....	4-5
Special Calibration.....	4-7
Specific Gravity.....	4-7
Voidless Density.....	4-8
Set Units.....	4-8
Calibration Constants.....	4-9
Memory Reset.....	4-9
Test Reading.....	4-9
15-Second Inhibit.....	4-10

TABLE OF CONTENTS (Continued)

APPENDIX A. 3411-B ELECTRICAL SPECIFICATIONS

Electrical Specifications A-2

APPENDIX B. PERIODIC MAINTENANCE AND SERVICE

Troubleshooting..... B-2
Battery Charging B-7
Replacement Parts B-8
Returning the Gauge for Service B-10
Troxler Service Centers B-11

INDEX

WARRANTY

LIST OF FIGURES

<u>Figure</u>	<u>Title</u>	<u>Page</u>
2-1	Model 3411-B ACU Keypad.....	2-2
2-2	Drill Rod Positioning	2-11
2-3	Marking the Test Area	2-11
2-4	Voids Illustration.....	2-15
B-1	Model 3411-B ACU Assembly	B-9

LIST OF TABLES

<u>Table</u>	<u>Title</u>	<u>Page</u>
2-1	Model 3411-B ACU Keypad Functions.....	2-3
3-1	K Values for Thin Lift Overlays	3-14

NOTES

ATTENTION GAUGE OWNER

*This unit contains functions that require an ACCESS CODE.
This code must be entered before these functions may be used.*

**The ACCESS CODE for the
Model 3411-B Advanced Control Unit is:**

4678

*This page should be removed if the access code is not to be
distributed to other parties or users of this gauge.*

NOTES

CHAPTER 1

INTRODUCTION AND INSTALLATION

This chapter introduces the Model 3411-B Advanced Control Unit (ACU) and provides instructions for installing it into a Model 3411-B gauge.

CONTENTS

Introduction.....	1-2
Installing the ACU	1-3
Entering the Calibration Constants	1-4

INTRODUCTION

The Model 3411-B Advanced Control Unit (ACU) enables the owner of a Troxler Model 3411-B Surface Moisture-Density Gauge to enjoy all the features and functions of our Model 3430 gauge for less than the cost of a new gauge. The ACU is a direct replacement for the 3411-B's original scaler and adds a number of improvements over the original:

- ◆ The ACU features a 2-line by 16-character alphanumeric liquid crystal display (LCD), providing more information to the gauge operator. The display features a backlight for greater visibility in low-light conditions.
- ◆ All gauge functions are controlled from a 10-key sealed-membrane keypad and software menus, for increased reliability over the original mechanical switches.
- ◆ The ACU provides built-in *statistical stability (stat) test* and *drift test* functions, eliminating the need for the operator to manually calculate the standard deviation and average of multiple readings while performing these tests.
- ◆ The ACU features moisture, density, and trench offsets, which enable the operator to adjust the gauge for use on materials not covered by the factory calibration.
- ◆ The ACU requires no calibration after its installation into a 3411-B gauge. The user simply enters the calibration constants from the gauge's factory calibration sheet, and the gauge is ready for use.

INSTALLING THE ACU

CAUTION

To prevent possible damage to electronic components from electrostatic discharge (ESD), Troxler recommends that the operator wear a grounded wrist strap while installing the Model 3411-B ACU.

To install the ACU in a 3411-B gauge:

- ✓ Loosen the four captive screws located in the corners of the 3411-B gauge's scaler (front panel).
- ✓ Gently pull the scaler out of the gauge, using care not to damage the ribbon cable connecting the scaler electronics to the gauge.
- ✓ Disconnect the ribbon cable from the scaler and set the scaler aside.
- ✓ Connect the ribbon cable to connector J8 on the Model 3411-B ACU. J8 is located on the circuit board labeled *110238 REV. X (TOP)*, where *X* is the current revision of the board. Ensure that the polarizing key on the ribbon cable connector is aligned with the slot in connector J8.
- ✓ Place the ACU into the gauge, using care not to pinch the ribbon cable. Secure the ACU using the four captive screws located in the corners of the ACU.
- ✓ Enter the gauge *calibration constants* as described in the following section.

NOTE

After installing the ACU, take a *standard count* as described on page 2–8 before using the gauge to take measurements. A standard count should also be performed any time the ACU is disconnected from the gauge.

ENTERING THE CALIBRATION CONSTANTS

The *calibration constants* are a set of mathematical constants used by the gauge when calculating a test result. These constants are developed when the gauge is calibrated, and are unique to a particular gauge. The constants for a gauge are listed on the most recent calibration sheet provided with the gauge.

NOTE

Each gauge contains a unique set of calibration constants. The constants used in one gauge will not work in another gauge! The constants for your gauge are developed when the gauge is calibrated and are reflected on the most recent calibration sheet.

NOTE

If the calibration sheet lists B and F values, instead of B*1000 and F*1000 values, then the calibration is in English, rather than metric, units. *Therefore, the B and F values must be converted to metric values and multiplied by 1000 before they are entered into the gauge. A more direct method is to multiply the B and F values by 62.4298, then enter the resulting products into the gauge.*

After installing the ACU as described on page 1–3, the calibration constants **must** be entered as follows.

The *Calibration Constants* feature is one of the gauge's *Special* functions. To access the *Special* functions, press **<SPECIAL>**.

To access the *Calibration Constants* feature, press the down arrow key eight times and press **<START/ENTER>**.

Enter code -
0

This feature requires the input of the access code found on page xi of this manual. Using the up and down arrow keys to select the correct number for the flashing digit, enter the access code. To accept the flashing value and select the next digit, press **<START/ENTER>**.

The gauge prompts for the input of the *E* value.

NOTE

If the value is negative, enter a minus sign (-) by pressing the down arrow key prior to entering the first digit. Leading zeros must be entered (for example: 0.012345).

To change the value of the flashing digit for the *E* value, use the up and down arrows. To accept the flashing value and select the next digit, press **<START/ENTER>**.

Enter the remaining constants for each depth.

NOTES

CHAPTER 2

OPERATING THE GAUGE

This chapter explains the basic operation of a Model 3411-B gauge after it has been retrofitted with a Model 3411-B Advanced Control Unit (ACU). Instructions for setting gauge parameters, taking the daily standard count, preparing the test site, positioning the gauge, and taking moisture and density measurements are included.

CONTENTS

The Keypad.....	2-2
Turning the Gauge On	2-4
Gauge Parameter Setup.....	2-5
Setting Measurement Units	2-5
Setting the Count Time	2-6
Setting the Depth.....	2-6
Selecting the Mode (Marshall/Proctor)	2-6
Taking the Standard Count	2-8
Site Preparation/Gauge Positioning	2-10
Soil and Base Course Preparation	2-10
Asphalt Surface Preparation.....	2-12
Taking a Measurement – Soil Mode.....	2-13
Taking a Measurement – Asphalt Mode.....	2-16

THE KEYPAD

The keypad (see Figure 2–1) of the Model 3411-B Advanced Control Unit (ACU) consists of ten keys — an eight-function keypad and the **<ON/YES>** and **<OFF/NO>** keys – and a backlight switch. The gauge is equipped with a beeper to verify keystrokes. If a *beep* is not heard when a key is pressed, the keystroke was not recognized and should be repeated. The **<ON/YES>** and **<OFF/NO>** keys are used for responses to specific questions displayed on the screen and to turn the gauge on and off.

The up and down arrows allow the operator to scroll through various function lists displayed by the gauge.

The backlight switch toggles the display backlight on and off.

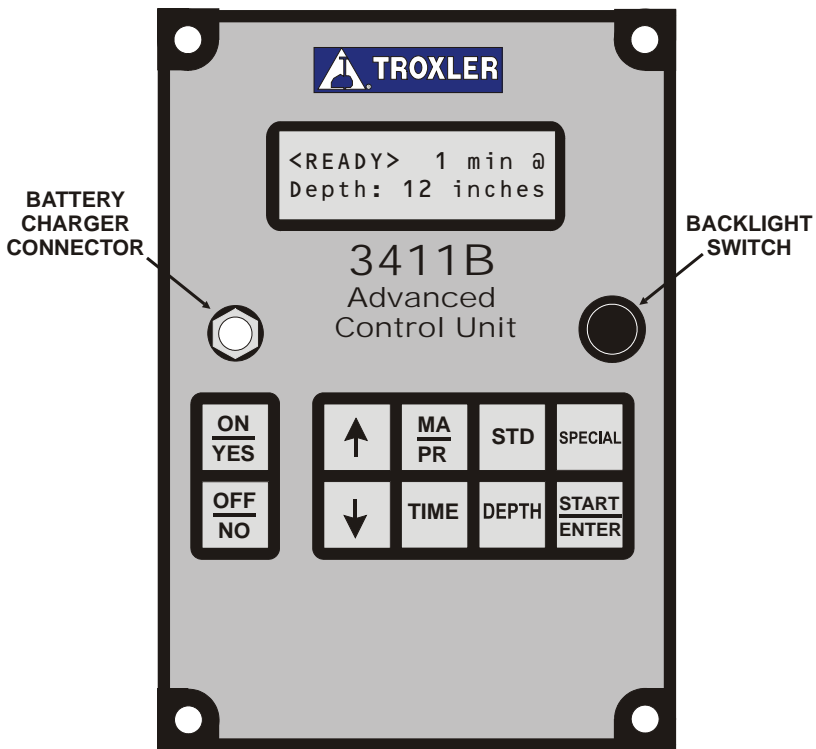

Figure 2–1. Model 3411-B ACU Keypad

Table 2–1 provides a more detailed description of the individual keys and the location in the manual where each function is described.

Table 2–1. Model 3411-B ACU Keypad Functions

KEYS	DESCRIPTION	PAGE
<u>ON</u> YES	Turns on the gauge and answers <i>Yes</i> to prompts.	2–4
<u>OFF</u> NO	Turns gauge off and answers <i>No</i> to prompts	
↑	Scrolls the display up.	
↓	Scrolls the display down.	
<u>MA</u> <u>PR</u>	Allows entering or enabling of a Proctor or Marshall value.	2–6
TIME	Allows the operator to change the count time.	2–6
STD	Use to access the <i>Standard Count</i> mode.	2–8
DEPTH	Allows entry of the source rod depth.	2–6
SPECIAL	Provides access to the <i>Special</i> functions.	2–5, 3–3, 3–4, 3–6, 4–1
<u>START</u> <u>ENTER</u>	Starts a measurement or completes answer entry.	

2. GAUGE OPERATION

TURNING THE GAUGE ON

The gauge uses rechargeable NiCad batteries (included) as a power source. When first turned on, the ACU displays test characters before proceeding to the self-test.

NOTE

If the gauge turns off immediately after it is turned on, the battery charge may be low or the gauge may be wet inside. Refer to Appendix B of this manual for information on battery charging, and to the *Model 3400-B Manual of Operation and Instruction* for information on inspecting and replacing gaskets.

To turn the gauge on, press **<ON/YES>**. The gauge performs a test of its liquid crystal display (LCD):

```
Testing LCD
0123456789ABCDEF
```

After the 300-second self-test, the gauge enters the *Ready* mode. In this state any of the gauge functions may be accessed.

The *Ready* mode display is:

```
<READY> x min @
Depth: xx inches
```

The first line of the display indicates the current *count time*. The second line of the display indicates the source rod depth that has been selected.

NOTE

The gauge will automatically turn off after five hours if no keys are pressed.

GAUGE PARAMETER SETUP

After unpacking the gauge and turning it on, there are several parameters that can be initialized. These parameters do not usually require changing and include the measurement units and count time.

SETTING MEASUREMENT UNITS

The ACU allows measurement results to be displayed in either metric or US units. To set the measurement units, first access the *Special* function menu by pressing **<SPECIAL>**. The gauge displays:

-RECALL-
(↑ ↓ or ENTER)

Press the down arrow seven times to display:

- SET UNITS -
(↑ ↓ or ENTER)

To select *Set Units*, press **<START/ENTER>**.

Units: PCF
(↑ ↓ or ENTER)

Use the up and down arrows to scroll through the available units. When the desired units are displayed, press **<START/ENTER>**.

SETTING THE COUNT TIME

The *count time* defines how long the gauge reads. Longer count times produce better measurement precision. Troxler recommends a count time of one minute for most sample measurements.

To change the count time, press **<TIME>** to display:



Time: x min
(↑ ↓ or ENTER)

Use the up and down arrows to scroll through the available count times. When the desired count time is displayed, press **<START/ENTER>**.

SETTING THE DEPTH

To change the depth of measurement, press **<DEPTH>**.

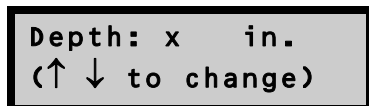

Depth: x in.
(↑ ↓ to change)

Use the up and down arrows to scroll through the available measurement depths. When the desired depth is displayed, press **<ON/YES>** to select the displayed depth and return to the *Ready* mode.

SELECTING THE MODE (MARSHALL/PROCTOR)

The gauge may be used on construction materials (soils, asphalt, concrete, and so on). To select the *Soil* mode, enter or activate a Proctor value. To select the *Asphalt* mode, enter or activate a Marshall value. Only one Marshall and one Proctor can be stored in the gauge at one time.

NOTE

To measure concrete, use either the *Asphalt* or *Soil* mode. For moisture results select the *Soil* mode. For density measurement only, use the *Asphalt* mode.

To enter or activate a Marshall or Proctor value, press **<MA/PR>**. The display will be one of the following:

MA: xxx.x (↑↓)
Change MA value?

PR: xxx.x (↑↓)
Change PR value?

To switch from a Marshall value to a Proctor value, or vice versa, use the arrow keys.

To activate the displayed value, press **<OFF/NO>**.

To change the displayed value, press **<ON/YES>**. The first digit of the value will flash. Use the arrow keys to scroll through the possible entries (0 – 9 and .). When the correct value for the current digit is displayed, press **<START/ENTER>**. The gauge will proceed to the next digit to the right.

When the value entry is complete, the gauge activates the value and returns to the *Ready* mode.

TAKING THE STANDARD COUNT

The gauge uses a cesium-137 and an americium-241:beryllium source for taking measurements. These radioactive sources undergo a natural decay process, resulting in a gradual loss in the intensity of their radiation. The time required for the source strength to diminish by 50% is referred to as the *half-life*.

To compensate for the source decay and to check proper operation of the gauge, a daily reference *standard count* should be performed. To ensure the highest accuracy possible with the gauge, it is important to take a daily standard count.

NOTE

A standard count should be performed after the ACU is installed before using the gauge to take measurements.

A standard count should also be performed any time the ACU is disconnected from the gauge.

The gauge is equipped with a reference standard block for taking the standard count. Place the reference standard block on a dry, flat surface at least three meters (10 ft) from any large vertical surface and at least ten meters (33 ft) from any other radioactive source. The surface should be asphalt, concrete or soil at least ten centimeters (4 in) thick and with a density of at least 100 pcf.

Place the gauge on the reference standard block. The right side of the gauge, farthest from the handle, should be against the metal butt plate.

To begin the standard count procedure, press **<STD>**.

**DS= xx MS= xx
New Std Cnt?**

To take a new standard count, press **<ON/YES>**.

**Press START for
Standard Count**

Ensure that the gauge is positioned as described above. To initiate the standard count, press **(START/ENTER)**. After the count is complete, the display will be:

Standard Count:
DS= xx MS= xx

Troxler recommends that the operator keep a daily log of the moisture and density standard counts (see the *Model 3400-B Manual of Operation and Instruction* originally supplied with the Model 3411-B gauge). To verify gauge stability, compare the daily standard count to a reliable reference as follows:

- ◆ During the first four days of operation of a new or recalibrated gauge, compare the daily standard count to the factory calibrated values.
- ◆ After the first four days of operation (or after taking four standard counts), compare the daily standard count to the average of the last four counts. Acceptable standard count limits are:

±1% each day for DS (density standard) and
±2% each day for MS (moisture standard).

After recording the standard counts, return to the *Ready* mode by pressing **(ON/YES)**.

SITE PREPARATION/GAUGE POSITIONING

Preparation of the test site surface is critical to gauge performance. This section provides site preparation procedures for both soils and base courses and asphalt surfaces. To ensure the most accurate gauge readings, the appropriate preparation procedure should be followed.

SOIL AND BASE COURSE PREPARATION

- ✓ Since soil surface conditions are critical to accurate measurements, locate a level site free from any large holes, cracks, or debris.
- ✓ Smooth the surface by moving the scraper plate in a back and forth motion. Filler such as fine sand may be used to decrease the surface voids.

NOTE

Use only enough filler to fill the voids. Too much filler will cause an error in the measurement.

- ✓ For direct transmission measurements, put the drill rod through the extraction tool and then through one of the guides on the plate (see Figure 2-2).
- ✓ **Wearing a radiation badge and safety glasses (or other locally approved safety devices)**, step on the plate and hammer the drill rod at least 50 millimeters (2 in) deeper than the desired test depth. The drill rod increments include the additional depth.
- ✓ Remove the drill rod by pulling straight up and twisting the extraction tool. **Do not loosen the drill rod by tapping from side to side with a hammer.** This will distort the hole or cause loose material to fall into the hole.
- ✓ To ensure accurate placement of the gauge, before removing the scraper plate mark the test area using the drill rod as shown in Figure 2-3.
- ✓ Carefully pick up the scraper plate and place the gauge on the surface prepared by the plate. Insert the source rod into the hole made by the drill rod. **Use care when inserting the source rod, trying not to disturb the soil around the hole.**

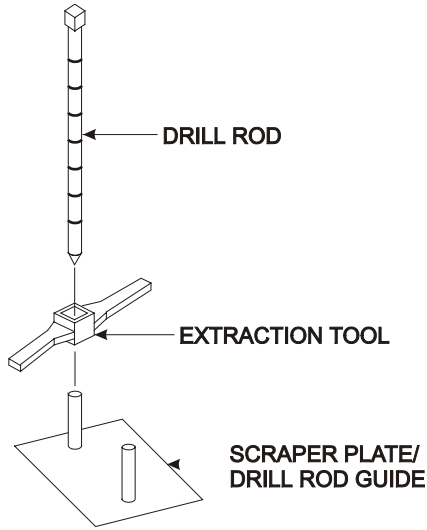

Figure 2–2. Drill Rod Positioning

- ✓ Lower the source rod into the hole. Release the trigger and lock the source rod into the correct position. A *click* should be heard when the source rod is locked into position.
- ✓ Gently slide the gauge toward the keypad so the source rod makes contact with the wall of the hole.

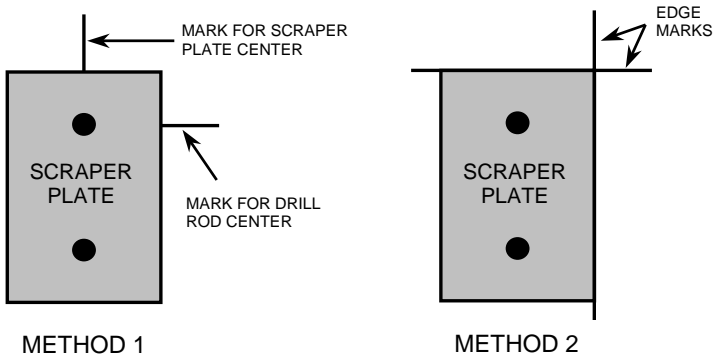

Figure 2–3. Marking the Test Area

ASPHALT SURFACE PREPARATION

It is possible, but usually not necessary, to take direct transmission readings on asphalt. Drilling a hole in asphalt can be difficult, and may require the use of a drill (rather than the drill rod) if the asphalt has cooled and hardened.

Under normal conditions, a backscatter reading provides an accurate measurement of asphalt density.

- ✓ Find a smooth, level location on the asphalt. The operator may want to fill the voids on open mixes with sand or cement. Take care to leave the asphalt exposed. **The gauge base must rest on the asphalt, not the fill material!**
- ✓ Ensure that the gauge does not “rock.” It must remain steady. If rocking occurs, find a more suitable test site. If taking a measurement around a core, the gauge may be moved a few inches away from the hole to level the gauge.

TAKING A MEASUREMENT – SOIL MODE

The *Soil* mode is automatically selected when a Proctor value is enabled (see page 2–6).



NOTE

When not taking measurements, always keep the source rod in the **SAFE** position. For added operator safety, the source rod on the gauge automatically retracts to the **SAFE** position when the gauge is lifted by the handle.

If you do not hear a *click* when the source rod is raised to the **SAFE** position, look at the bottom of the gauge to verify that the sliding block is completely closed. If the gauge base opening is not completely closed by the sliding block, the sliding block may require cleaning. Refer to the *Model 3400-B Manual of Operation and Instruction* for cleaning instructions.



CAUTION

Do not store or transport the gauge unless the sliding block is completely closed. Increased radiation levels may violate transportation regulations and cause excessive personnel exposure.

Place the gauge over the test site. Release the gauge handle and push it down until it is in the correct position. Ensure that the pin engages the notch in the index rod.

Press **<START/ENTER>**.

Depth:	xx	in.
Time:	xxx	sec.

After the count time has elapsed, the gauge displays the measurement results in a series of six screens, as follows. Use the up and down arrows to scroll through the various screens.

```
M Count:   xxx
D Count:   xxx
```

```
WD:       xxx.x PCF
(Use ↑ & ↓ keys)
```

```
DD:       xxx.x PCF
% PR:     xx.x   %
```

```
Moist:    xxx.x PCF
% Moist:  x.x    %
```

```
Air Void: xx.x %
Void Ratio x.xxx
```

```
MOIST CR: x.xxx
DENS. CR:  x.xxx
```

where:

M Count = Moisture counts as read by the gauge

D Count = Density counts as read by the gauge

WD = Wet density in kg/m^3 or pcf

DD = Dry density in kg/m^3 or pcf

%PR = Percent Proctor (This value is valid only if an appropriate target has been entered for the material being tested.)

MOIST = Moisture value in kg/m^3 or pcf

% MOIST = Percent moisture

Air Void = See description below

Void Ratio = See description below

MOIST CR = Moisture count ratio

DENS. CR = Density count ratio

Press **<ON/YES>** to return to the *Ready* mode.

Figure 2–4 illustrates the terms *void ratio* and *% air voids*. The *void ratio* is the ratio of the volume occupied by air and water in the soil to the volume occupied by solid particles. The term *% air voids* refers to the volume of air voids only as a percentage of the total volume.

The following formulas are used to calculate the *% air voids* and *void ratio* values.

$$\% \text{ AIR VOIDS} = 100 (1 - (V_s/V_t) - (V_w/V_t))$$

where:

V_s = Volume of Soil

V_t = Total Volume

V_w = Volume of Water

or,

$$\% \text{ AIR VOIDS} = 100 (1 - (DD / SG(D_w)) - (M / (D_w)))$$

where:

D_w = Density of Water

SG = Specific Gravity of Soil Particles

DD = Dry Density

M = Moisture

$$\text{VOID RATIO} = \text{Volume of Voids} / \text{Volume of Soil} \\ = (SG(D_w) - DD) / DD$$

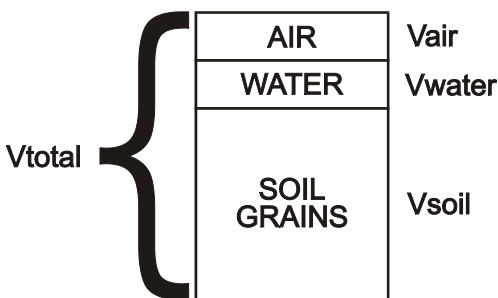

Figure 2–4. Voids Illustration

TAKING A MEASUREMENT – ASPHALT MODE

The *Asphalt* mode is automatically selected when a Marshall value is enabled (see page 2–6).



NOTE

When not taking measurements, always keep the source rod in the SAFE position. For added operator safety, the source rod on the gauge automatically retracts to the SAFE position when the gauge is picked up by the handle.

If you do not hear a *click* when the source rod is raised to the **SAFE** position, look at the bottom of the gauge to verify that the sliding block is completely closed. If the gauge base opening is not completely closed by the sliding block, the sliding block may require cleaning. Refer to the *Model 3400-B Manual of Operation and Instruction* for cleaning instructions.



CAUTION

Do not store or transport the gauge unless the sliding block is completely closed. Increased radiation levels may violate transportation regulations and cause excessive personnel exposure.

Place the gauge over the test site. Release the gauge handle and push it into the backscatter position. Set the depth to *Backscatter*. Ensure that the pin engages the notch in the index rod. Gently tap the handle down to ensure proper source rod seating.

Press **<START/ENTER>**.

**Depth: BACKSCAT.
Time: xxx sec.**

After the count time has elapsed, the gauge displays the measurement results in a series of six screens, as follows. Use the up and down arrows to scroll through the various screens.

```
M Count:   xxx
D Count:   xxx
```

```
WD:       xxx.x PCF
% MA      xx.x %
```

```
DD:       xxx.x PCF
(Use ↑ & ↓ keys)
```

```
Moist:   xxx.x PCF
% Moist:  x.x %
```

```
% Voids:  xx.x %
100-%MA:  xx.x %
```

```
MOIST CR:  x.xxx
DENS. CR:  x.xxx
```

where:

WD = Wet density in kg/m^3 or pcf

% MA = Percent Marshall (This value is valid only if an appropriate target has been entered for the material being tested.)

DD = Dry density in kg/m^3 or pcf

MOIST = Moisture value in kg/m^3 or pcf

% MOIST = Percent moisture

% VOIDS = $100 (1 - \text{WD}/\text{VOIDLESS})$

100 - % MA = Value given by subtracting the percent Marshall value from 100

MOIST CR = Moisture count ratio

DENS. CR = Density count ratio

M Count = Moisture counts as read by the gauge

D Count = Density counts as read by the gauge

Press **<ON/YES>** to return to the *Ready* mode.

NOTES

CHAPTER 3

ADVANCED GAUGE OPERATION

This chapter provides instructions for using the Model 3411-B Advanced Control Unit (ACU) in special circumstances where the gauge may require an offset or special calibration. This chapter also explains the procedure for using the gauge to measure *thin layers* of asphalt.

CONTENTS

Offsets.....	3-2
Density Offset	3-3
Moisture Offset	3-4
Trench Offsets.....	3-6
Special Calibrations	3-8
Entering a New B Value.....	3-9
Gauge-Calculated Calibration	3-10
Thin Layer Measurements	3-12
Example.....	3-13

OFFSETS

The Model 3411-B gauge is factory-calibrated for soils, asphalt, and concrete with an approximate density range of 1100 to 2700 kg/m³ (70 to 170 pcf). With an *offset*, the operator can adjust the gauge readings to correlate to traditional laboratory methods, such as core samples. The Model 3411-B ACU provides three offsets: *density*, *moisture*, and *trench*.

NOTE

When an offset has been enabled, all future readings will automatically be adjusted with the offset factor regardless of the test site. It is very important that the operator *disable* the offset function prior to taking readings on materials that do not require an offset. Offsets are disabled if the gauge is turned off for more than 10 seconds.

Density offsets are common when the material being measured is outside the range of 70 to 170 pcf (1121 to 2723 kg/m³) or if the material composition varies from average soil/asphalt on which the factory calibration is based.

Moisture offsets are required for accurate measurements if the material to be measured contains elements that can cause the gauge to yield erroneous results. A *negative* offset is required if the material to be measured is high in hydrogenous components such as cement, gypsum, coal, or lime. A *positive* offset is required if the material is high in neutron-absorbing material such as boron or cadmium.

The gauge requires an offset if measurements are to be taken inside a trench or close to vertical structures. Vertical structures can scatter neutrons and gamma photons back to the gauge, increasing the possibility of moisture or density errors due to high counts.

DENSITY OFFSET

To access the *Special* functions, press **<SPECIAL>**.

Press the down arrow key once to access the *Offset* function. Press **<START/ENTER>** to display:

```
Offset: Density
(↑ ↓ or ENTER)
```

Press **<START/ENTER>**.

```
Dens. Offset OFF
Want to Enable?
```

To enable the *Density Offset* function, press **<ON/YES>**.

```
D off= 0.0 PCF
(↑ ↓ or ENTER)
```

Input the difference between the gauge and actual density readings. To input a minus sign (for a negative offset), press the down arrow first. To scroll through the numerals, press up and down arrows.

To select the next digit and/or exit, press **<START/ENTER>**.

The display will be:

```
Dens. Offset ON
```

MOISTURE OFFSET

Some soils contain hydrogen sources other than water and/or neutron absorbers. Since the gauge measures moisture by determining the hydrogen content of the material and relating this to the water content, both types of material could cause gauge readings that differ from the true moisture. If measuring such materials, use a moisture offset to adjust the readings.

The offset factor (k) is determined by comparing the moisture content of a laboratory sample with the moisture content determined by a gauge reading. To determine the offset factor, use the following procedure:

- ✓ Take a gauge reading at the site. Record the reading ($\%M_{GAUGE}$).
- ✓ Remove a sample from the measurement site, then use laboratory methods (for example, oven dry, and so on) to determine the moisture content of the sample ($\%M_{LAB}$). Multiple samples and measurements may be taken. Calculate the average moisture of the samples. This average value should be used for the offset factor calculation.
- ✓ Calculate the offset factor (k).

$$k = \frac{\%M_{LAB} - \%M_{GAUGE}}{100 + \%M_{GAUGE}} \times 1000$$

NOTE

If the k value is negative, enter a minus sign (–) by pressing the down arrow before entering the first digit.

To access the *Special* functions, press **<SPECIAL>**.

Press the down arrow key once to access the *Offset* function. Press **<START/ENTER>** to display:

Offset: Density
(↑ ↓ or ENTER)

To enter a moisture offset, press the down arrow once and press **<START/ENTER>**.

Moist Offset OFF
Want to enable?

To enable the *Moisture Offset* function, press **<ON/YES>**.

K= 0.0
(↑ ↓ or ENTER)

The first digit will flash. To input a minus (–) sign (for a negative offset), press the down arrow first! To scroll through the possible values for each digit, press the arrow key. To select the next digit, press **<START/ENTER>**. When all digits are entered, the gauge will enable the offset. The display will be:

Moist Offset ON

TRENCH OFFSETS

If the gauge is to be used for moisture or density measurements in a trench or within two feet (0.6 m) of a large vertical structure, a trench offset may be required. If used, the trench offset adjusts all moisture measurements but only the density measurements from backscatter through four inches (10 cm).

To perform a trench offset:

- ✓ Take the daily standard count (outside the trench) and record the density count (DS) and moisture count (MS) values.
- ✓ Place the gauge on the reference standard block in the trench the same distance from the wall as the anticipated readings. **Do not take another standard count.**
- ✓ Set the count time to four minutes.
- ✓ With the source rod in the **SAFE** (standard count) position, take a four-minute count. To start the count, press the **<START/ENTER>** key.
- ✓ Record the trench density count (DC_{Trench}) and moisture count (MC_{Trench}).
- ✓ Subtract the daily standard count values from the trench count values:

$$Dens\ Cnst = (DC_{Trench}) - DS$$

$$Mois\ Cnst = (MC_{Trench}) - MS$$

To enable a trench offset, press **<SPECIAL>** to access the *Special* functions, then press the down arrow key once to access the *Offset* function. Press **<START/ENTER>** to display:

Offset: Density
(↑ ↓ or ENTER)

To enter a trench offset, press the down arrow twice and press **⟨START/ENTER⟩**.

Trench Offs. OFF
Want to enable?

To enable the *Trench Offset* function, press **⟨ON/YES⟩**.

Mois Cnst:- 0
(↑ ↓ or ENTER)

The gauge requests the *Mois Cnst* and *Dens Cnst* values determined earlier. The procedure for entering the values is the same as for moisture and density offsets, **ignoring the ± sign on the display**.

When the values are complete, the gauge enables the offset and displays:

Trench Offset
ENABLED

SPECIAL CALIBRATIONS

Troxler gauges are calibrated to “average soil.” Average soil is defined as material consisting of 50% limestone (calcareous) and 50% granite (siliceous). This factory calibration provides accurate results for the majority of materials encountered in the field. However, there are situations when varying material compositions could affect the gauge accuracy. In these special cases the gauge *B value* can be recalculated either by the gauge or by considering the mass attenuation (μ/ρ) of the material.

If the chemical composition of the soil is known, Troxler can provide a procedure for recalculating the B value for manual entry (see page 3–9) to accurately measure the soil density. This calculation requires in-depth knowledge of the gauge geometry and the detected energy spectrum of the Cs-137 source.

The *Special Calibration* function allows the gauge to be recalibrated for material densities and compositions other than those covered by the factory calibration.

The true density of a sample of the material must be obtained prior to calculating a special calibration. This density may be obtained from a laboratory sample.

To access the *Special* functions, press **<SPECIAL>**.

To access the *Special Calibration* function, press the down arrow four times. Press **<START/ENTER>** to display:

**SPECIAL CALIB.
Want to Recalib?**

To recalibrate the gauge for the densities outside the factory calibration range, press **<ON/YES>**. To disable the *Special Calibration* feature, press **<OFF/NO>** at the above display and **<ON/YES>** at the disable inquiry. After disabling this feature, the gauge will return to the *Ready* mode.

**SPECIAL CALIB.
Enter B Value?**

To enter a known B value obtained with the procedure available from Troxler, press **<ON/YES>**. To have the gauge calculate the recalibration, press **<OFF/NO>**. If entering a new known B value, see the following explanation. For gauge-calculated special calibration, see page 3–10.

ENTERING A NEW B VALUE

**Depth: xx in.
(↑ ↓ or ENTER)**

To change the value of the flashing digit for the measurement depth, use the up and down arrows. To accept the flashing value and select the next digit, press **<START/ENTER>**.

**B VAL = x.xxxxx
(↑ ↓ or ENTER)**

The gauge displays the current B value. To change the value of the flashing digit, use the up and down arrows. To accept the flashing digit and select the next digit, press **<START/ENTER>**.

Upon entry completion, the gauge will indicate that the special calibration is enabled and return to the *Ready* mode. Note that when the gauge is turned off the *Special Calibration* is disabled.

**SPECIAL CALIB.
ENABLED!**

GAUGE-CALCULATED CALIBRATION

The true density of the sample must be determined, and a gauge reading must be performed on the material in order to calculate and enable a special calibration.

NOTE

When using destructive methods such as drilling cores or sample removal for true density measurement, take gauge readings before removing samples.

To select the depth and/or exit, press **⟨START/ENTER⟩**.

**Depth: xx in.
(↑ ↓ or ENTER)**

To scroll through the numerals for the depth of the measurement, press the up and down keys. To select the next field and/or exit, press **⟨START/ENTER⟩**.

If calibration counts have not been taken, the gauge will take four one-minute counts.

The gauge provides the operator with a partial calibration feature. A partial calibration allows the operator to enter the density *after* taking counts, which is helpful to those performing destructive material testing. If the operator has previously taken calibration counts, the gauge asks if these counts should be used in calibrating the gauge. To use the previous counts, press **⟨ON/YES⟩**. The gauge will then request the density. To take new counts, press **⟨OFF/NO⟩**.

Press **START** for
Reading # x

Place the gauge on the test material. To begin taking the four one-minute counts, press **<START/ENTER>**. After each count is complete, the operator must initiate the next count by pressing **<START/ENTER>**.

Enter known
density now?

To create a partial calibration and return to the *Ready* mode, press **<OFF/NO>**. To complete the special calibration by entering the density, press **<ON/YES>**.

Density: x.x
(↑ ↓ or ENTER)

To change the value of a digit, press the up and down arrows. To select the next digit, press **<START/ENTER>**. After the density value is entered, the special calibration routine readjusts the gauge for the new material and indicates that the special calibration is enabled. The special calibration is only valid for the depth selected during the special calibration.

**SPECIAL CALIB.
ENABLED!**

THIN LAYER MEASUREMENTS

Conventional backscatter gauges measure density to depths of approximately 4 inches. To perform readings on layers of asphalt with thickness of 3.33 inches or less, use the following method (formula):

$$DT = \frac{WD - DB \times K}{1 - K}$$

where:

DT = Overlay density

WD = Density read by gauge

DB = Bottom layer density

K = Effect of top layer thickness on the gauge

To use the above method of overlay measurement, follow the procedure below:

- ✓ Determine the density of the bottom layer (underlying material) (*DB*).
- ✓ Apply the thin lift overlay.
- ✓ Determine the thickness of the overlay and select the corresponding (*k*) value from Table 3–1 on page 3–14.
- ✓ Measure the thin lift overlay density with the gauge in backscatter position (*WD*).
- ✓ Enter all values into the above equation and calculate the overlay density (*DT*).

EXAMPLE

Given the following values:

Bottom Density (DB) = 135 pcf (2162 kg/m³)

Overlay Thickness = 1.2 inches (30 mm)

K (from Table 4-1) = 0.38235

Density read by gauge (WD) = 142.0 pcf (2275 kg/m³)

$$DT = \frac{142.0 - (135 \times 0.38235)}{1 - 0.38235}$$

$$DT = 146.3 \text{ pcf}$$

or,

$$DT = \frac{2275 - (2162 \times 0.38235)}{1 - 0.38235}$$

$$DT = 2345 \text{ kg/m}^3$$

NOTE

The majority of the backscattered gamma rays reaching the detectors are the result of interactions in the top 3.3 inches (84 mm) of the overlay. In applications where the overlay thickness is greater than 3.3 inches (84 mm), use (0) for the *k* value or use the actual gauge readings (WD).

Table 3-1. K Values for Thin Lift Overlays

Thickness (inches)	Thickness (mm)	K
1.0	25	0.46159
	26	0.44787
	27	0.43414
1.1	28	0.42042
	29	0.40138
1.2	30	0.38235
	31	0.36475
	32	0.35889
1.3	33	0.34716
	34	0.33631
	35	0.32547
1.4	36	0.31462
	37	0.29958
1.5	38	0.28454
	39	0.27527
	40	0.26600
1.6	41	0.25673
	42	0.24387
1.7	43	0.23102
	44	0.22310
	45	0.21517
1.8	46	0.20725
	47	0.19626
1.9	48	0.18527
	49	0.17850
	50	0.17172
2.0	51	0.16495
	52	0.15556
2.1	53	0.14617
	54	0.14038

Thickness (inches)	Thickness (mm)	K
	55	0.13459
2.2	56	0.12880
	57	0.12078
2.3	58	0.11275
	59	0.10781
	60	0.10285
2.4	61	0.09790
	62	0.09104
2.5	63	0.08418
	64	0.07995
	65	0.07572
2.6	66	0.07149
	67	0.06562
2.7	68	0.05976
	69	0.05615
	70	0.05253
2.8	71	0.04892
	72	0.04390
2.9	73	0.03889
	74	0.03580
	75	0.03271
3.0	76	0.02962
	77	0.02676
	78	0.02391
3.1	79	0.02105
	80	0.01709
3.2	81	0.01313
	82	0.01069
	83	0.00825
3.3	84	0.00581

CHAPTER 4

SPECIAL FUNCTIONS

This chapter gives brief explanations of the *Special* functions available on the Model 3411-B Advanced Control Unit (ACU), or directs the reader to the appropriate section dealing with a particular function.

CONTENTS

Recall	4-2
Offset	4-2
Stat Test	4-2
Drift Test.....	4-5
Special Calibration.....	4-7
Specific Gravity	4-7
Voidless Density	4-8
Set Units.....	4-8
Calibration Constants.....	4-9
Memory Reset.....	4-9
Test Reading	4-9
15-Second Inhibit.....	4-10

RECALL

The *Recall* function allows the operator to view the data from the **last** reading. Even though the ACU does not store multiple readings, this function displays the latest data.

To access the *Special* functions, press **<SPECIAL>**.

To access the *Recall* feature, press **<START/ENTER>**.

The gauge displays the data from the last measurement. Scroll through the screens using the up and down arrow keys.

OFFSET

For information on offsetting gauge readings, refer to page 3–2.

STAT TEST

The *statistical stability test*, or *stat test*, may be performed to validate the normal operation of the gauge. Erratic readings or readings that seem to fluctuate may indicate a problem with the gauge. In the event the readings are suspect, a stat test may be executed.

A *stat test* consists of 20 one-minute counts. After the 20 counts, the gauge calculates the standard deviation. This standard deviation is compared to a theoretical standard deviation value. Ideally this ratio should be one. However, the ACU pre-scales (or divides) the counts by 16, resulting in an ideal ratio of 0.25. The acceptable limits for the ratio are from 0.17 to 0.33. The gauge is considered to be unstable if the ratio is outside these limits.

To perform a stat test, place the gauge on the reference standard block in the standard count position (see page 2–8).

To access the *Special* functions, press **⟨SPECIAL⟩**.

To access the *Stat Test* feature, press the down arrow twice and press **⟨START/ENTER⟩**.

```
press START for
20 m. Stat Test
```

To begin the twenty counts, press **⟨START/ENTER⟩**.

The gauge will display the stat test count progress as shown below.

```
- STAT TEST -
Rdg.#:xx xx sec
```

Upon completion of the stat test, the gauge displays the pass/fail status. If the stat test fails, repeat the test twice more. If two out of three stat tests fail, contact Troxler Technical Support (see page B-11). If the stat test passes, the display is:

```
D: PASS M: PASS
↑↓ to view data
```

To view the stat test data, use the up and down arrow keys.

```
Dens. R = x.xxx
↑↓ to view data
```

```
Dens. Avg. x
↑↓ to view data
```

Moist R = x.xxx
↑↓ to view data

Moist Avg. x
↑↓ to view data

•
•
•

#20D xxx M xxx
(Use ↑ & ↓ keys)

DRIFT TEST

If the stat test has already been performed (and passed), but gauge readings seem to drift between tests, the *drift test* can check the long-term drift of the gauge.

A drift test consists of 5 four-minute counts taken approximately three to eight hours after completion of a stat test ***with no movement of the gauge between tests***. Pass/fail limits are set using the percent difference between the average of the stat and drift test results. If the percent difference exceeds 0.5% for density or 1% for moisture, the drift test fails.

NOTE

The gauge should *not* be turned off between the stat test and drift test. The stat test *must* be current.

In addition, the gauge must not be moved between the stat and drift tests to eliminate possible failure due to positioning changes.

With the gauge still in the standard count position (on the reference standard block), press **<SPECIAL>**.

From the *Special* functions, select the *Drift Test* feature by pressing the down arrow three times and **<START/ENTER>**.



press START for
20 m. Drift Test

To begin the five counts, press **<START/ENTER>**.



- DRIFT TEST -
Rdg.#:xx xxx sec

As with the stat test, the gauge indicates the count progress during the drift test.

After the five counts have been completed, the display is:

```
D: PASS M: PASS
↑↓ to view data
```

To view the drift test data, use the up and down arrow keys.

```
D % Drift xx.xx
↑↓ to view data
```

```
Dens. Avg. xx
↑↓ to view data
```

```
M % Drift xx.xx
↑↓ to view data
```

•
•
•

```
# 5 D xx M xx
(Use ↑ & ↓ keys)
```

SPECIAL CALIBRATION

For information on performing a special calibration, see Chapter 3.

SPECIFIC GRAVITY

The specific gravity of a solid is defined as the density of the material divided by the density of water. The *Specific Gravity* function allows the operator to input the specific gravity of a material into the gauge. This value (SG) is used in the calculation of % Air Voids and Void Ratio (see Chapter 2).

To access the *Special* functions, press **<SPECIAL>**.

To access the *Specific Gravity* feature, press the down arrow five times and press **<START/ENTER>**.



SG = 2.70
(↑ ↓ or ENTER)

To change the value of the flashing digit, use the up and down arrows. To accept the flashing value and select the next digit, press **<START/ENTER>**.

If a value is not entered, the default value is 2.70, the “typical” specific gravity for soil.

VOIDLESS DENSITY

The *Voidless Density* function allows the input of the *theoretical* voidless density value of the material being measured. This value is used in the % Voids calculation.

To access the *Special* functions, press **<SPECIAL>**.

To access the *Voidless Density* feature, press the down arrow six times and press **<START/ENTER>**.



VD = xxx.x
(↑ ↓ or ENTER)

To change the value of the flashing digit, use the up and down arrows. To accept the flashing value and select the next digit, press **<START/ENTER>**.

SET UNITS

For information on the *Set Units* feature, see page 2–5.

CALIBRATION CONSTANTS

The *Calibration Constants* function allows the operator to change the mathematical constants used for calculating a test result. If the gauge has been repaired or the memory has been lost, the constants **must** be verified or re-entered.

NOTE

Each gauge contains a unique set of constants. The constants used in one gauge will not work in another gauge! The constants for your gauge are developed when the gauge is calibrated and are reflected on the most recent calibration sheet.

For more information on the *Calibration Constants* feature, refer to page 1–4.

MEMORY RESET

NOTE

This function is for authorized service personnel only!

CAUTION

Memory Reset erases all data stored in the gauge and sets all constants, except calibration constants, to the default values.

TEST READING

NOTE

This function is for authorized service personnel only!

15-SECOND INHIBIT

The *15-Second Inhibit* function enables the gauge owner or operator to disable the 15-second count option. When this function is enabled, the gauge can only conduct one- or four-minute counts.

To disable the 15-second count option, first access the *Special* functions by pressing **<SPECIAL>**. Use the up or down arrows to display:

- 15 SECONDS -

To access the *15-Second Inhibit* function, press **<START/ENTER>**.

Enter Code -
0

This feature requires the input of the access code found in the front of this manual. Using the up and down arrow keys to select the correct number for the flashing digit, enter the access code. To accept the flashing value and select the next digit, press **<START/ENTER>**.

- ▶ If the 15-second count option is currently enabled, the gauge displays:

- 15 SECONDS -
Want to DISABLE?

Press **<ON/YES>** to disable the 15-second count option. The gauge returns to the *Ready* mode.

- ▶ If the 15-second count option is currently disabled, the gauge displays:

- 15 SECONDS -
Want to ENABLE?

Press **<ON/YES>** to enable the 15-second count option. The gauge returns to the *Ready* mode.

APPENDIX A**3411-B ELECTRICAL SPECIFICATIONS**

This appendix contains the electrical specifications for the Model 3411-B Surface Moisture-Density Gauge when retrofitted with the Model 3411-B Advanced Control Unit (ACU). Note that the measurement, radiological, mechanical, and calibration specifications of the Model 3411-B are not affected by the retrofit, and are therefore unchanged from those shown in the *Model 3400-B Manual of Operation and Instruction* originally supplied with the gauge.

CONTENTS

Electrical Specifications	A-2
---------------------------------	-----

ELECTRICAL SPECIFICATIONS

Stored Power	40 watt-hours
Battery Recharge Time	14 to 16 hours
Gauge Charging Requirements	12 V dc, 500 mA minimum
Liquid Crystal Display	2 line x 16 character alphanumeric
Keypad	10-key sealed membrane
Power Consumption	< 0.10 watts average

APPENDIX B

PERIODIC MAINTENANCE AND SERVICE

This appendix contains information on troubleshooting a Model 3411-B gauge when retrofitted with the Model 3411-B Advanced Control Unit (ACU), as well as information on charging the gauge battery. If a serious problem with the gauge arises, contact Troxler Technical Support (see page B-11) for instructions.

CONTENTS

Troubleshooting	B-2
Possible Malfunction Indicators	B-6
Error Messages	B-6
Battery Charging	B-7
Replacement Parts	B-8
Returning the Gauge for Service	B-10
Troxler Service Centers	B-11

TROUBLESHOOTING

GAUGE FAILS STANDARD COUNTS

- ✓ Ensure that the source rod opening on the gauge bottom is completely closed or covered by the tungsten sliding block. If any opening is visible, the sliding block should be cleaned as described later in the *Model 3400-B Manual of Operation and Instruction*. If the sliding block still does not close completely, contact the nearest Troxler Technical Support (see page B-11).
- ✓ Compare the current standard counts to the calibration standard counts. If they are within 1% for DS and 2% for MS, accept the standard count, then perform and accept four more standard counts.

NO DENSITY READINGS

- ✓ The most likely reason for no density readings is an electronic problem, such as a failure of the detector preamplifier. However, as a precaution, ensure that the tip of the source rod is intact and undamaged (that is, ensure that the source is not missing). Use a radiation survey meter to check the radiation levels on contact with the surface of the gauge base (without extending the source rod). A maximum reading of 10-20 mrem/hr is normal, and indicates the source is present. However, if the maximum reading is less than 1 mrem/hr or if a survey meter is not available, perform a visual inspection of the source rod tip as follows to confirm its integrity:
 1. Extend the source rod just far enough to see the source rod tip. The tip should appear flat to slightly rounded and smooth.
 2. Stay at least three feet away from the tip of the unshielded source rod and complete the inspection as quickly as possible to minimize exposure (the dose rate at three feet from the unshielded source is about 2.7 mrem/hr).

If the visual inspection indicates that the source rod tip is broken off (source is missing):

1. Immediately contact your Radiation Safety Officer (RSO).
2. Initiate a search for the source starting at the location where the gauge was last used.
3. Report lost or missing radioactive sources to your state or federal radiation control agency in accordance with applicable regulatory requirements.
4. Contact the Troxler Radiation Safety Department for further advice.

GAUGE READINGS APPEAR ERRATIC

- ✓ Ensure that the source rod is properly locked in the desired backscatter or direct transmission position, and is not resting on the test material.
- ✓ Check the inside of the gauge for moisture. To dry the gauge interior, remove the keypad. If necessary, use a hair dryer (on low heat) to circulate warm air for one to three hours.
- ✓ Remove any foreign objects from inside the gauge.
- ✓ Ensure the hardware mounting screws are tight and in place.
- ✓ Check count time – a four-minute count will give the highest precision with a repeatability of ± 1 pcf.
- ✓ Erratic density readings may be caused by a dirty sliding block. Clean the sliding block as described in the *Model 3400-B Manual of Operation and Instruction*.
- ✓ Perform a statistical stability (stat) test (see page 4–2).
 - ▶ If test passes, proceed with job.
 - ▶ If test fails, repeat two more times. If test fails two out of three times, contact Troxler Technical Support (see page B-11).

NOTE

To aid in verifying gauge readings, after a gauge has been calibrated, mark a test area on a concrete floor, sidewalk, or equivalent and measure the density (WD). This measurement can then be used as a reference to verify later gauge readings.

GARBAGE OR XXXXXX IS DISPLAYED

- ✓ Check the standard counts in memory. If the standard counts are suspect, perform new standard counts. If counts equal zero for both systems, replace high voltage board. Contact Troxler Technical Support (see page B-11).
- ✓ Check gauge for water damage. If the gauge is wet, dry the gauge interior with hairdryer (on low heat) for 3 hours.
- ✓ Check the calibration constants. They should match the constants on your calibration data sheet **if your calibration sheet is in metric units**. (Refer to the note on page 1-5 to determine if your calibration sheet is in metric units and, if not, for instructions on converting B and F values from English to metric units.)
- ✓ If necessary, perform a statistical stability (stat) test (see page 4-2), record the results and contact Troxler Technical Support (see page B-11).

GAUGE TURNS OFF AFTER IT IS TURNED ON

- ✓ The gauge automatically turns off after five hours if no keys are pressed. Try to turn the gauge on again.
- ✓ The gauge may be wet. Do not turn the gauge on until moisture is removed from gauge interior! Component damage may result.
- ✓ If the battery is below 3.0 volts, recharge or replace the batteries.
- ✓ The scaler may be defective. To test, replace the suspect scaler with a good scaler.

SHORT BATTERY LIFE AFTER RECHARGING

- ✓ NiCad batteries may be charged up to 100 full charge-discharge cycles. The batteries may be reaching end of life cycle - replace. Note that all information stored in the gauge except the calibration constants and the chosen language is lost when the batteries are disconnected.
- ✓ Charger/adapter may not be supplying full charge – check the ac outlet and the dc output (12 V dc).
- ✓ Check the output voltage of your charger. The correct output voltage is indicated on the charger unit.
- ✓ Check that you are using the correct charger.
- ✓ Remove any loose screws or foreign objects from the gauge interior that may cause an electrical short to ground.
- ✓ The ac charger may be defective. Check voltage output of charge with a voltmeter, or use the dc charger to charge the batteries.

SATISFACTORY COUNTS, BUT RESULTS ARE IN ERROR

- ✓ Ensure the measurement depth corresponds to the actual source rod depth.
- ✓ Check calibration constants.
- ✓ Check to see if an offset (density, moisture, trench or special) is enabled.
- ✓ Ensure that the standard counts are correct.
- ✓ Ensure that the index rod is seated in bottom of notch.

POSSIBLE MALFUNCTION INDICATORS

CPU Board

Display Malfunctions
No Keypad Response
RAM Test Fails
Batteries Do Not Recharge
Battery Low Indicator Does
Not Function Correctly

Display Test Fails
Gauge Doesn't Turn "Off"
Beeper Stops (or is erratic)
Gauge Does Not Turn On

When Charger Is Connected

Preamp Board

No Moisture or Density Counts
Batteries Do Not Recharge

Gauge Fails Tube Test
Fails Stability or Drift Tests

HV Board

No Moisture or Density Counts
Moisture or Density Counts are
Unstable

Batteries Discharge
Prematurely
Gauge Fails Stability or Drift
Tests

ERROR MESSAGES

The following error messages are not user-serviceable. Contact Troxler Technical Support (see page B-11) for more information.

KEY PAD TEST ERROR!

GM TUBE TEST ERROR!

HELIUM TUBE TEST ERROR!

DISPLAY TEST ERROR!

BATTERY CHARGING

With fully charged batteries, the gauge will remain operational for approximately eight weeks under normal (8-hour day) conditions.

If the batteries become discharged, the following message will be displayed on the gauge:

***** WARNING! ***
Battery Low!**

When this display appears, there are a few hours remaining before the battery must be recharged. In an emergency, a 30-minute recharge with the dc or ac charger gives several hours of use.

Although batteries cannot be “overcharged,” rechargeable batteries have a “memory” and repeated unnecessary recharging will shorten the battery life. If possible, run the batteries down before recharging.

NOTE

Batteries should not be recharged unless the Battery Low! indication is displayed!

REPLACEMENT PARTS

Figure B-1 shows the replaceable parts of the Model 3411-B Advanced Control Unit.

Match the reference number (Ref #) shown below with the correct part in Figure B-1.

<u>Ref #</u>	<u>Part Number</u>	<u>Description</u>	<u>Qty</u>
1	000001.0400	#4 Internal Lock Washer	4
2	000204.1400	4-40 Pan Head Screw, Phillips	4
3	001061.0820	4-40 Hex Spacer, MF	4
4	002516	Jack Cover Assembly	1
5	100528.1000	Captive Thumb Screw, 8-32	4
6	102888	Cable Assembly	1
7	110237 (Bottom)	Printed Circuit Board Assembly	1
8	110237 (Top)	Printed Circuit Board Assembly	1
9	110240	Operator Overlay	1
10	110241	Front Panel Assembly	1
11	110245	Charger Jack Assembly	1
12	110248	Cable Assembly	1
13	110254	Cable Assembly, Backlight	1

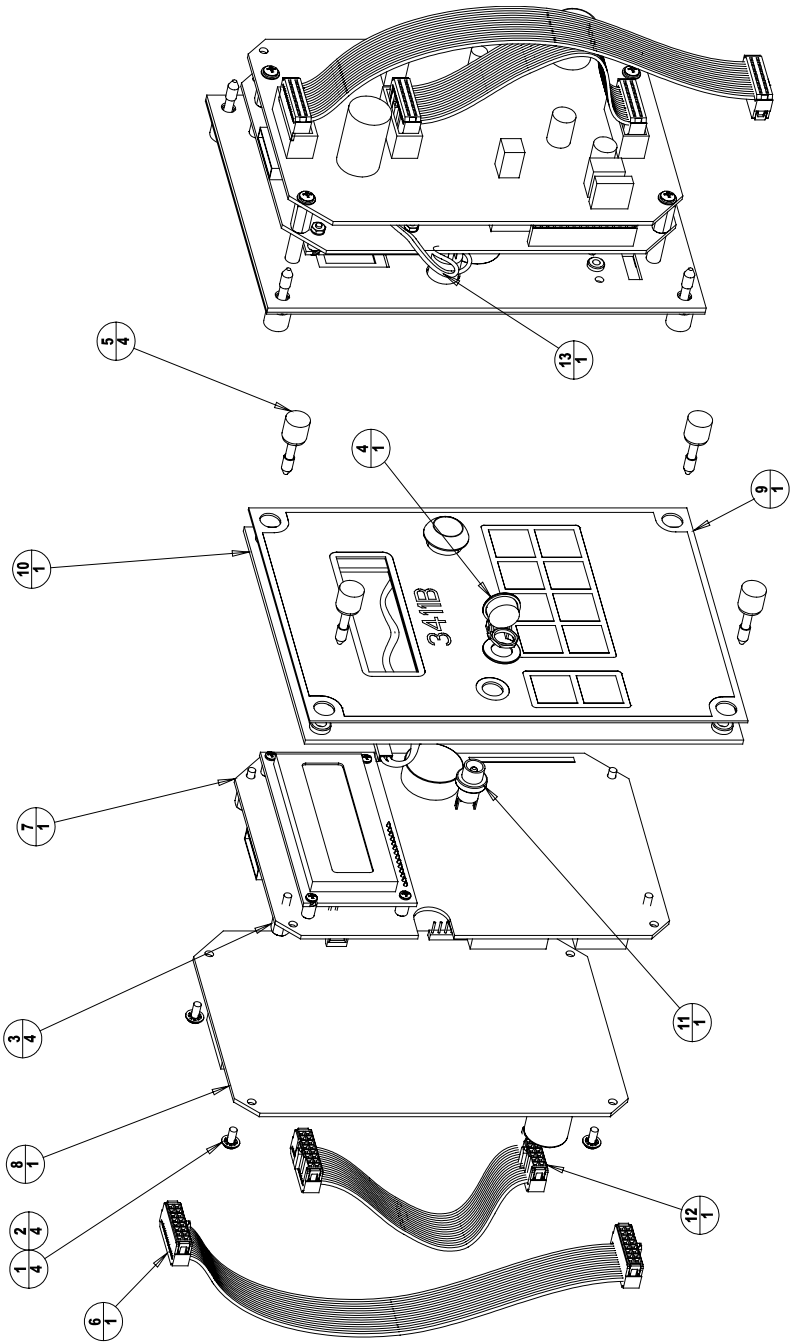

Figure B-1. Model 3411-B ACU Assembly

RETURNING THE GAUGE FOR SERVICE

All shipments to the factory from within the United States must be accompanied by an RGA (Returned Goods Authorization) number, and a description of the instrument and its problem. This information is used by Troxler shipping and service personnel to expedite the repair work.

To obtain an RGA number, please call or fax the factory or branch office with your request. Please have the following information available when contacting Troxler for an RGA number:

- ◆ Gauge model and serial number.
- ◆ Part number/serial number (if applicable).
- ◆ Is the gauge still under warranty?
- ◆ Problem or difficulty you are having with the instrument.
- ◆ Shipment method to Troxler and for return shipment.
- ◆ Shipping and billing address (not P.O. Box) – street address and zip code.
- ◆ Telephone number and contact (for questions from Troxler).
- ◆ Will estimate be required before performing any work on the gauge?
- ◆ Payment method: credit card, account number, or purchase order number. All U.S. government agencies (city, county, state and federal) must send purchase order numbers.

NOTE

To prevent order duplication, if an order has been placed by telephone, please write “Confirming Order” on any follow-up written requests.

NOTE

Returning a gauge requires special handling and shipping procedures. Follow the instructions in the *Model 3400-B Manual of Operation and Instruction* originally provided with the gauge. Please contact Troxler Technical Support (see page B–11) with any questions.

TROXLER SERVICE CENTERS

Troxler Corporate Headquarters

3008 Cornwallis Road
P.O. Box 12057
Research Triangle Park, NC 27709
Phone: 1.877.TROXLER (1.877.876.9537)
Outside the U.S.A.: +1.919.549.8661
Fax: +1.919.549.0761
Web: www.troxlerlabs.com

Technical Support

Phone: 1.877.TROXLER (1.877.876.9537)
E-mail: TroxTechSupport@troxlerlabs.com

Midwestern Branch Office

1430 Brook Drive
Downers Grove, IL 60515
Fax: 630.261.9341

Florida Service Center

2376 Forsyth Road
Orlando, FL 32807
Fax: 407.681.3188

Western Regional Branch Office

11300 Sanders Drive, Suite 7
Rancho Cordova, CA 95742
Fax: 916.631.0541

Canadian Branch Office

7125 Pacific Circle, Unit 13
Mississauga, Ontario L5T-2A5
Canada
Fax: 905.564.7092

Southwestern Branch Office

2016 East Randol Mill Road
Suite 406
Arlington, TX 76011
Fax: 817.275.8562

Troxler European Subsidiary

Troxler Electronics GmbH
Gilchinger Strasse 33
D.82239 Alling nr. Munich, Germany
Phone: ++49.8141.71063
Fax: ++49.8141.80731
E-mail: troxler@t-online.de

NOTES

INDEX

1

15-Second inhibit..... 4-10

A

Access code xi

Asphalt mode 2-6

Automatic shutdown 2-4

B

Backlight..... 1-2, 2-2

Battery charging.....B-7

C

Calibration

 Constants..... 1-4, 4-9

 Special..... 3-8

Code, access..... xi

Count time 2-6

D

Density

 Offset 3-3

 Voidless 4-8

Depth of measurement 2-6

Drift test 4-5

E

Error messages.....B-6

I

Installation 1-3

K

Keypad..... 2-2

M

Measurement	
Asphalt mode.....	2-16
Depth	2-6
Mode.....	2-6
Site preparation.....	2-10
Soil mode.....	2-13
Thin layer	3-12
Units	2-5
Memory reset.....	4-9
Mode	
Asphalt	2-6
Ready.....	2-4
Soil	2-6
Moisture offset	3-4

O

Offset.....	3-2
Density	3-3
Moisture	3-4
Trench.....	3-6

P

Parts, replacement	B-8
Percent air voids	2-15

R

Ready mode.....	2-4
Recall.....	4-2
Replacement parts	B-8

S

Service	
Centers.....	iii, B-11
Returning gauge	B-10
Shutdown, automatic	2-4
Soil mode.....	2-6

Special	
Calibrations.....	3-8
Functions.....	4-1
Specific gravity.....	4-7
Specifications.....	A-1
Standard count.....	2-8
Stat test.....	4-2

T

Taking a measurement	
Asphalt mode.....	2-16
Soil mode.....	2-13
Test	
Drift.....	4-5
Stat.....	4-2
Test reading.....	4-9
Thin layer measurements.....	3-12
Time, count.....	2-6
Trench offset.....	3-6
Troubleshooting.....	B-2

U

Units, measurement.....	2-5
-------------------------	-----

V

Void ratio.....	2-15
Voidless density.....	4-8

NOTES

NOTES

WARRANTY

TROXLER ELECTRONIC LABORATORIES, INC.

LIMITED WARRANTY

TROXLER ELECTRONIC LABORATORIES, INC., and subsidiary, TROXLER INTERNATIONAL, LTD., hereinafter referred to as "TROXLER," warrants this instrument, the Model 3411-B Advanced Control Unit, Serial Number _____, against defects in material and workmanship for a period of six (6) months from date of shipment. For units sold through authorized TROXLER representatives, the date of shipment will be as of the transfer from representative to purchaser. During the applicable warranty period, TROXLER's obligation under this warranty shall be limited exclusively to the repair at no charge, except for shipping to and from TROXLER'S plant, of any instrument which may prove defective under normal use and which TROXLER's examination shall disclose to its satisfaction to be thus defective. Normal use is defined for the purpose of this warranty as operation under normal load, usage, and conditions with proper care and maintenance and competent supervision. In no event shall TROXLER be held liable for damages, delays, or losses consequential, incidental, or otherwise attributable to the failure of this instrument. TROXLER's liability being specifically limited to repair as stated hereinabove. This warranty is automatically initiated except where modified by contractual or other written and signed agreement.

THERE ARE NO WARRANTIES WHICH EXTEND BEYOND THE DESCRIPTION ON THE FACE HEREOF, AND THIS WARRANTY IS EXPRESSLY IN LIEU OF ALL OTHER WARRANTIES, EXPRESSED OR IMPLIED, AND TROXLER NEITHER ASSUMES, NOR AUTHORIZES ANYONE TO ASSUME FOR IT ANY OTHER LIABILITY IN CONNECTION WITH THE SALE OF THE INSTRUMENT. THIS WARRANTY SHALL NOT APPLY TO THE INSTRUMENT OR ANY PART WHICH HAS BEEN SUBJECTED TO DAMAGE BY ACCIDENT, NEGLIGENCE, ALTERATION, ABUSE, MISUSE, OR SERVICE NOT AUTHORIZED IN WRITING BY TROXLER. SUCH DAMAGE TO INCLUDE BUT NOT BE LIMITED TO BURNING OF CIRCUIT BOARDS AND HARNESS FROM IMPROPER SOLDERING TECHNIQUES AND DAMAGE TO THE INSTRUMENT DUE TO PURCHASER'S FAILURE TO PERFORM MAINTENANCE AS OUTLINED IN THE AUTHORIZED OPERATOR'S MANUAL. DUE TO THE NATURE OF THEIR USE, MECHANICAL ACCESSORY PARTS AND BATTERIES ARE WARRANTED FOR NINETY (90) DAYS FROM SHIPMENT DATE.

TROXLER ELECTRONIC LABORATORIES, INC.

Troxler International, Ltd.
Troxler Electronics (Canada), Ltd.
3008 Cornwallis Road
Post Office Box 12057
Research Triangle Park, NC 27709 USA

NOTICE TO CONSUMERS

Any disclaimer or limitation on the remedies expressed above shall not be effective to the extent prohibited by state or federal law.

NOTE: THIS WARRANTY EXCLUDES DAMAGE INCURRED IN SHIPMENT. IF THIS INSTRUMENT IS RECEIVED IN DAMAGED CONDITION, THE CARRIER SHOULD BE CONTACTED IMMEDIATELY. ALL CLAIMS FOR DAMAGE IN TRANSIT SHOULD BE FILED WITH THE CARRIER. IF REQUESTED, TROXLER WILL AID IN FILING OF CLAIMS AND/OR LOCATING GAUGES LOST IN TRANSIT.